

Manotick Secondary Plan – Results



Village Plan
Review –
December 6, 2011

Overview

1. Re-cap of process
2. “As we heard it” responses
3. Refresh
 - changes to plan
 - recommended initiatives
4. What we need today?
5. Next steps



Spring Re-cap



... Re-cap

PLANNING AND GROWTH MANAGEMENT DEPARTMENT

MANOTICK

VILLAGE REVIEW PUBLIC WORKSHOP

"As we heard it"

Responses to “As we heard it” (ottawa.ca/ruralreview)

- **Input – summarized & categorized**
- **Follow-up with others**



.... Responses

Comments	Departmental Response
<p>Village Core</p> <p>Businesses should be focused primarily in the existing core and uses should not be segregated e.g. mixed-use with commercial located at grade with residential use above.</p>	<p>Manotick Main Street and the Mews are areas that are intended to accommodate commercial uses. Along Manotick Main Street residential uses can be located above commercial uses.</p>
<p>Could the property located at the corner of Manotick Main Street and Clapp Street occupied by a double decker bus be improved? This business is better suited for a better location and the site could be used as a parking lot.</p>	<p>This property currently occupied by a double decker bus serving food is zoned VM (Village Mixed-Use Zone). It permits a wide range of commercial, institutional and residential uses including bank, convenience store, medical facility, library and multiple attached dwellings. The landowner can establish any use permitted in the zoning for this property.</p>
<p>Manotick can emulate the type of development in Stittsville since it has both a main street and shopping plaza/big box stores.</p>	<p>Manotick has a vibrant main street with unique shops, restaurants and offices. Like Stittsville, Manotick's main street is located near a shopping centre. Manotick has much to offer to residents and visitors.</p>

.... Responses



- **Village Core**
 - **sidewalk condition**
 - **lack of pedestrian crossings**
 - **lack of connections to rest of the Village, Rideau River e.g. sidewalks/bicycles/pathways**
 - **speeding**
 - **parking – a problem?**

... Responses

- **Watson's Mill – status, ideas**



... Responses

Transportation

- **Bridge Street traffic – trucks & pedestrians**



... Responses

- Van Vliet extension



.... responses

- Area transportation issues**
- Mahogany development**

... Responses

- **Suggested road improvements
e-mail: traffic@ottawa.ca**
- **Transit suggestions**
- **Visioning efforts in village**

“As we heard it”

Assessment of Plan

- More work needed to update plan**

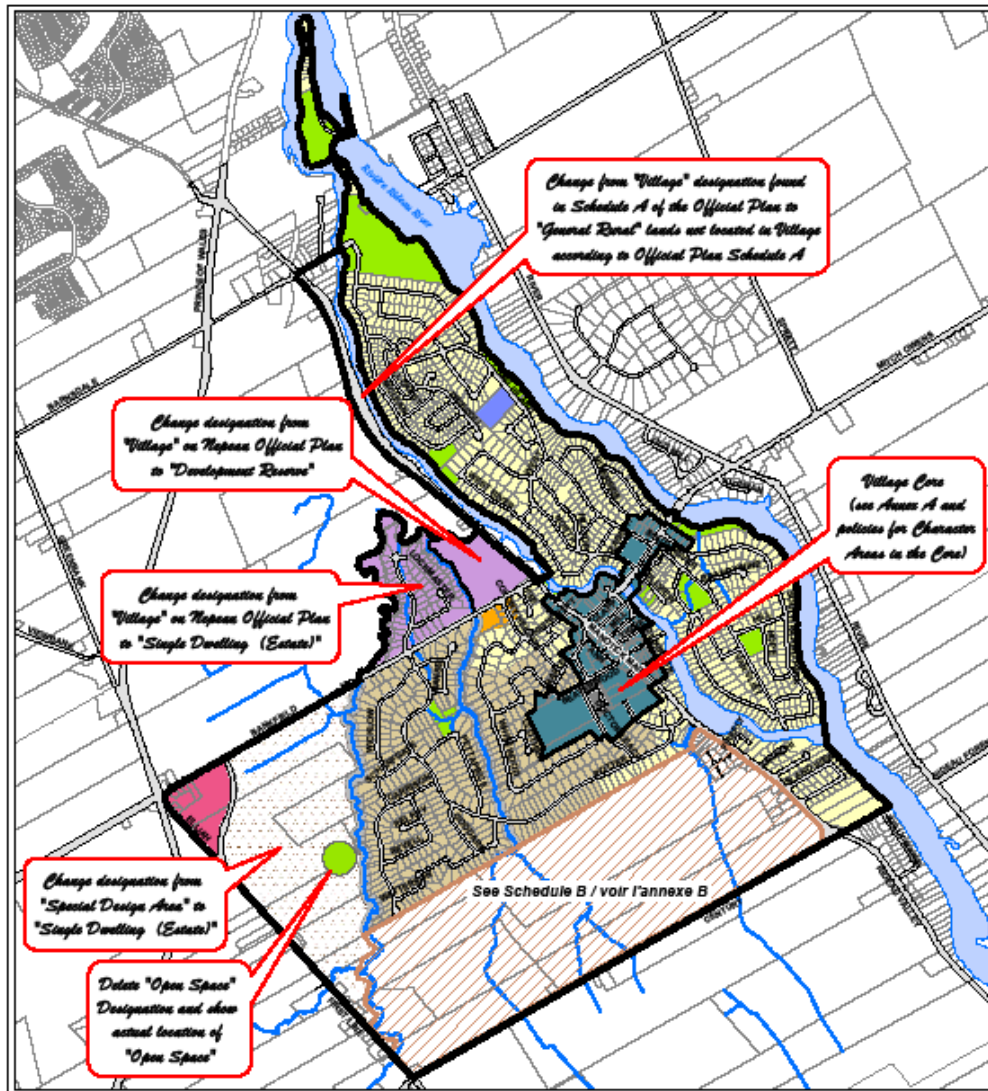

MANOTICK

SECONDARY PLAN
Schedule A - Land Use

PLAN SECONDAIRE
Annexe A - Utilisation du sol

OFFICIAL PLAN / PLAN OFFICIEL - VILLAGE

- Single Dwelling (Estate) / Unifamilial (domestique)
- Single Dwelling (Low Density) / Unifamilial (faible densité)
- Single Dwelling (Moderate Density) / Unifamilial (densité moyenne)
- Mixed Use Development / Aménagement polyvalent
- Open Space / Espace libre
- School / École
- Development Setback / Marge de recul
- ~~Special Design Area / Zone de design spéciale~~
- ~~Village on Nepean Official Plan / Village en vertu du Plan officiel de Nepean~~
- Village Core (Policy 4.2.2.2) / Cœur de village (Politique 4.2.2.2)
- Mahogany Community / Communauté Mahogany (see Schedule / voir l'annexe B)
- Development Reserve / Terrain d'aménagement futur
- Village Boundary / Limite du village

Scale / Echelle 1:25,000 approx.

0 125 250 500 750 1,000 Meters

© 2011. All rights reserved. May not be reproduced without permission. Plan/Plan approuvé par le Conseil municipal de Manotick. Tous droits réservés. Ne peut être reproduit sans autorisation.

Prepared by Infrastructure Services and Community Sustainability / Planning Department / Urban Services / Mapping and Graphics / Préparé par le Service d'Infrastructure et d'Utilité des services communautaires / Urbanisme et Conception de l'environnement / Cartographie et Conception.

10 / 8211

... Refresh

- **Revise numbering – start at 1.0**
- **Replace word “family” with “dwelling”**
- **Update facts**
- **Fix typos**

Future work

- **Village Core and Connectivity study**



... Future work

- **Employment strategy - review**

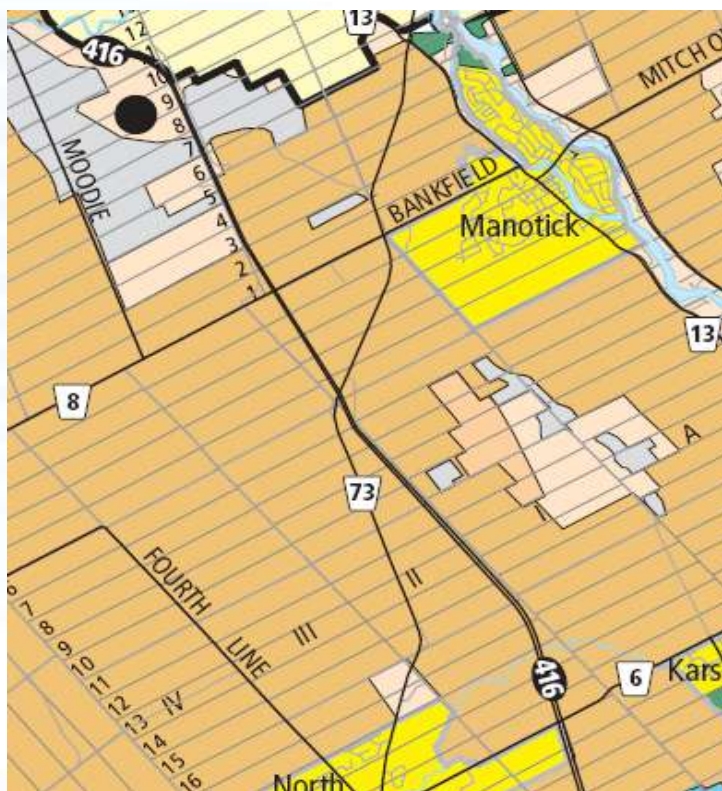

... Future work

- **Updated servicing policies**
- **Potential update for Mill quarter**
- **Conformity of zoning to land use**
- **Parking requirements**

What's next?

- **Comments by December 30th 2011**
- **Staff report on recommended changes – 1st quarter to Committee and City Council**

What we need from you?

- **Your feedback on results**
 - 1. Feedback on materials?**
 - 2. Anything we missed?**
- **Comments to: plan@ottawa.ca**